

Vigilis-Bio Tree Shelters

Natural, Degradable Tree Shelters

SHENANDOAH
HABITATS

Vigilis-Bio degradable tree shelters are designed to function in the same way as standard tree shelters, protecting young trees and other woody plants (such as vines) from animal damage and herbicide spray.



The unique material used to make Vigilis-Bio is radically different from standard polypropylene tree shelters.

After a minimum service life of five years, the Vigilis-Bio tree shelter is designed to start to break up. Over time, the particles and small fragments come into contact with the soil and act as a food source for soil bacteria and micro-organisms, eventually being absorbed harmlessly into the natural environment.

No need to remove them; no need to send them for recycling or composting; Vigilis-Bio simply degrades naturally in the soil leaving no plastics or other harmful substances behind. All that remains is water, carbon dioxide and a natural minerals.

Grow stronger, trees, faster.

- Protect from voles, rabbits, and deer
- Reduce moisture stress, resulting in higher survival rates and faster growth
- Shield from herbicide spray, mowers and weed whackers
- Laser perforation line, so the tree shelter will split and expand as your trees grow
- Flared rim to prevent bark abrasion to emerging trees
- Pre-threaded zip ties to fasten to the stake (stake not included)

Flared Rim

Helps protect young trees

Releasable Ties

For easy installation

Twin-Walled

An extra layer of protection

Laserline

Offers quick and easy removal



Vigilis-Bio Tree Shelters

How to Install Tree Shelters



Prep the Site and Plant the Seedling

Remove an 8-10" circular section of sod where you plan to plant your seedling. Plant in the center of the prepped area. The hole you dig needs to be the depth of your root length.



Install the Shelter Over the Seedling

Place the shelter over the seedling, holding branches to prevent them from catching on the bottom of the shelter. Be sure the ties do not catch any part of the seedling inside the tube.

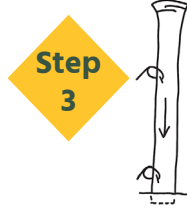

Secure the Shelter in the Soil

Using your hands, push the shelter 2" into the ground, rotating as you push down.

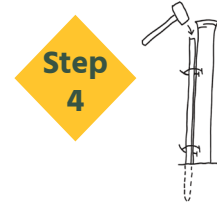

Install the Hardwood Stake

Slide the stake through the ties and hammer into the ground, leaving 1-3" of stake above the top tie. Make sure the stake is installed straight into the ground. Tighten ties.

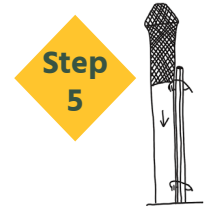

Install the Bird Mesh Guard

Slide bird mesh over shelter, pulling down until a small hole appears in top of mesh.

Maintenance
Inspect the shelter yearly. Clear weeds around the shelter and remove the bird net once it begins to grow out of the top of the shelter.

Removal
Once the tree is 2" in diameter at chest height remove the shelter completely.

Specifications

Materials	Unique formula from Biome Biotechnologies Ltd
Construction	Twin walled tube construction with a laserline to prevent strangulation
Rim	Flared upper rim to minimize abrasion
Fastenings	Pre-fitted with releasable zip ties
Color	Green color allows the correct balance of light wavelengths to be absorbed by the tree — a process called photomorphogenesis
Lifespan	UV-stabilized to provide an estimated lifespan of a minimum of 5 years, dependent on site conditions
Height	2', 4', and 5'
Diameter	Ranges from 3 to 4 inches

